

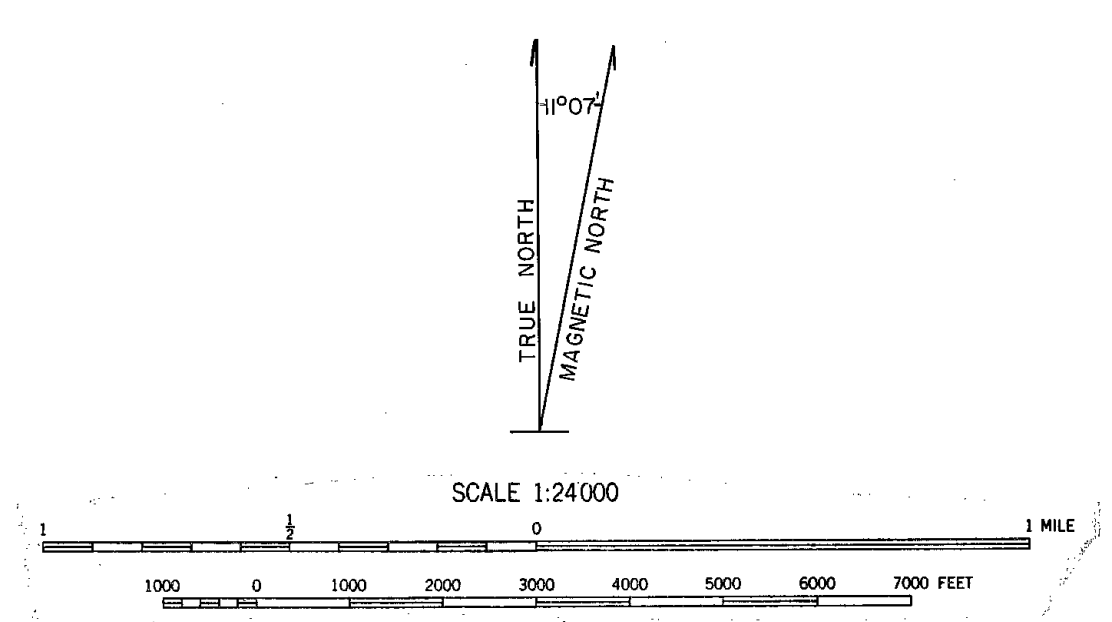

- SPECIFICATIONS**
1. SURVEY FLOWN WITH GEOMETRICS PROTON PRECESSION MAGNETOMETER MODEL 6803
 2. SAMPLING RATE - 0.5 SEC./11 GAMMA SEN.
 3. FLIGHT ELEVATION 1000 MTC. (Drops)
 4. FLIGHT LINES E/W 1 MILE APART
 5. CORRECTED FOR IORF 1975 UPDATED TO DATE FLOWN
 6. CONTOUR INTERVAL - 10 & 50 GAMMAS
 7. FLOWN MAY 1976



NEW MEXICO BUREAU OF MINES
CONTOUR MAP FOR
HELICOPTER GEOPHYSICAL SURVEY
 TORTUGAS MOUNTAIN PROJECT
 DONA ANA COUNTY, NEW MEXICO

by
 **aerial geophysics inc**
SALT LAKE CITY, UTAH 84111

MAY 1979

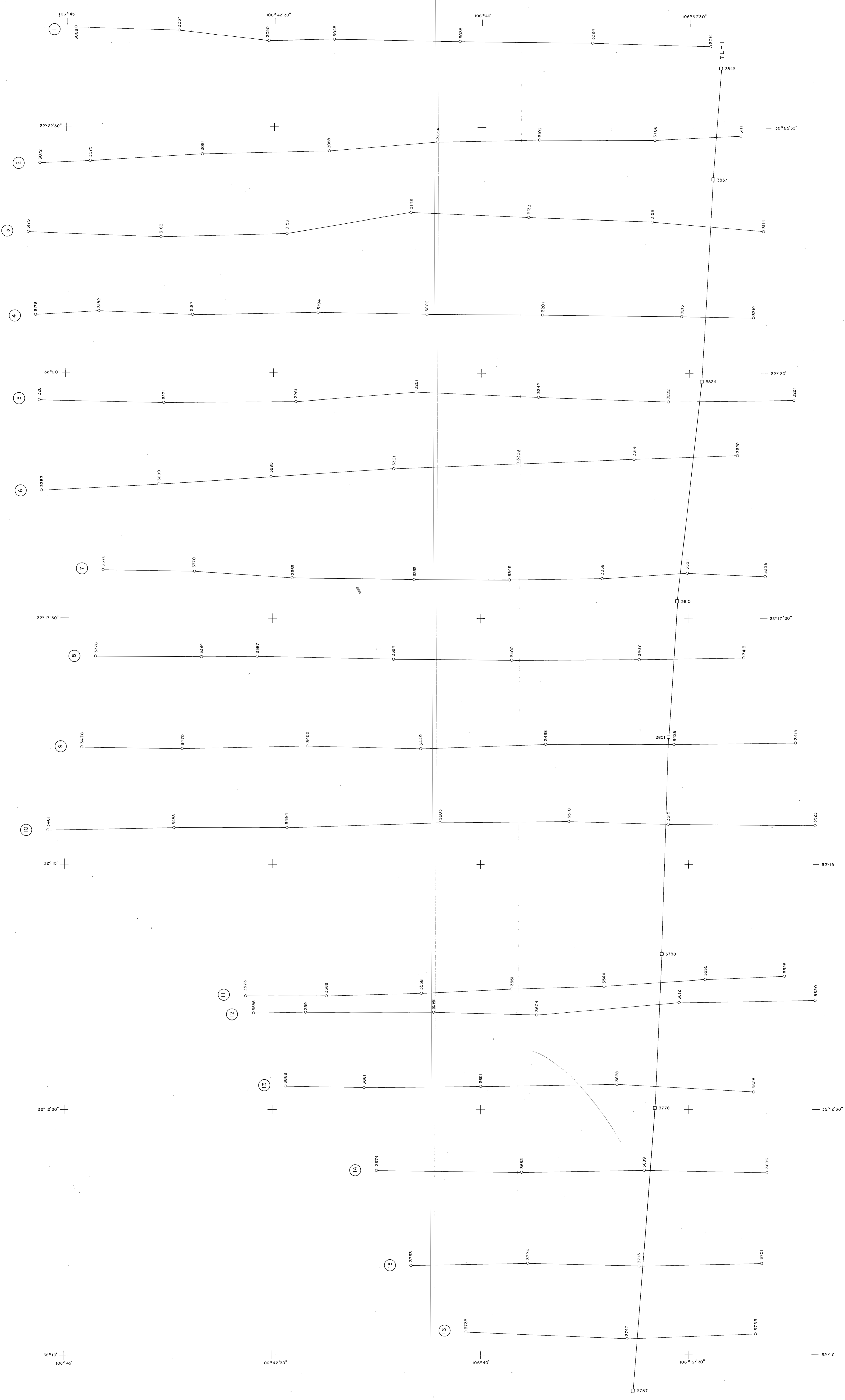

NEW MEXICO BUREAU OF MINES
 FLIGHT PATH MAP FOR
 HELICOPTER GEOPHYSICAL SURVEY
 TORTUGAS MOUNTAIN PROJECT
 DONA ANA COUNTY, NEW MEXICO

by
 aerial geophysics inc.
 SALT LAKE CITY, UTAH 84111

MAY 1979

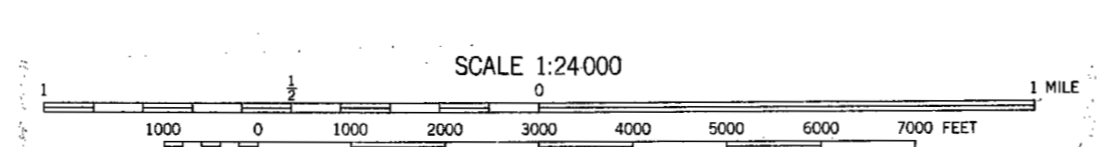

106°37'30"

106°37'30"

106°37'30"

106°37'30"

106°35'

106°35'

106°32'30"

106°32'30"

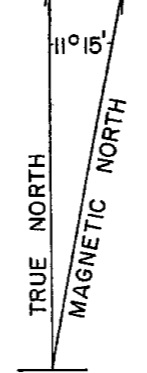
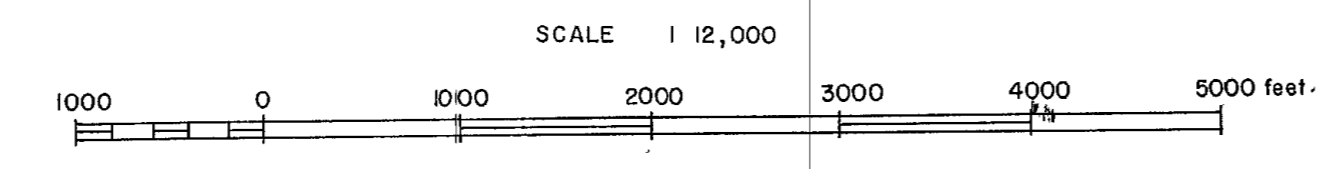
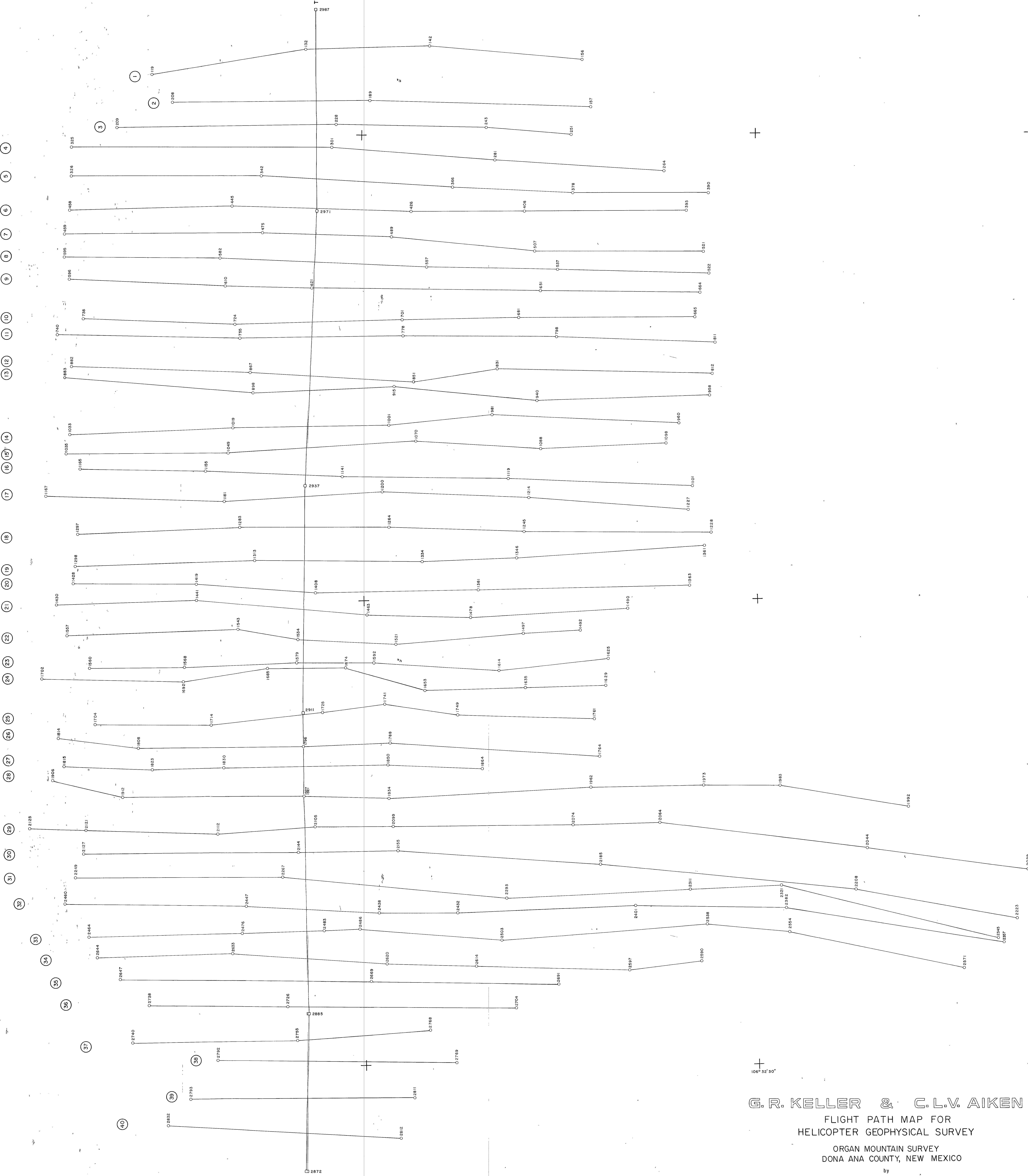

G. R. KELLER & C. L. V. AIKEN

FLIGHT PATH MAP FOR
HELICOPTER GEOPHYSICAL SURVEY

ORGAN MOUNTAIN SURVEY
DONA ANA COUNTY, NEW MEXICO

by
aerial geophysics inc
SALT LAKE CITY UTAH 84111

MAY 1979

106° 37' 30"

106° 35'

106° 32' 30"

32° 25' 30"

32° 25'

32° 22' 30"

32° 22' 30"

32° 20' 30"

106° 37' 30"

106° 32' 30"

32° 20'

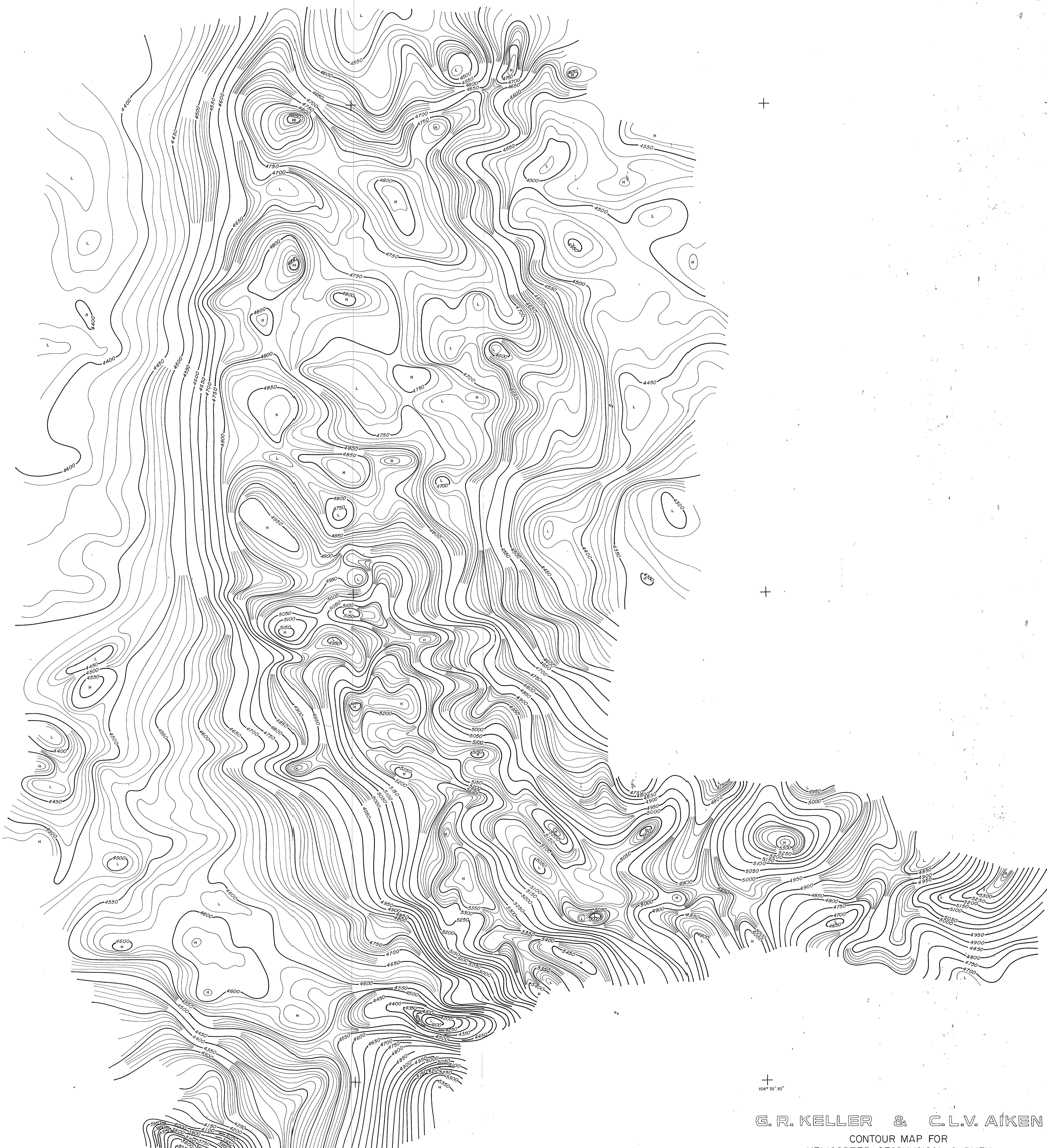

G. R. KELLER & C. L. V. AIKEN

CONTOUR MAP FOR
HELICOPTER GEOPHYSICAL SURVEY

ORGAN MOUNTAIN SURVEY
DONA ANA COUNTY, NEW MEXICO

by

aerial geophysics inc.
BOLT LANE CITY, UTAH 84111

MAY 1979

SPECIFICATIONS

- 1 SURVEY FLOWN WITH GEOMETRICS PROTON PRECESSION MAGNETOMETER MODEL 6803
- 2 SAMPLING RATE 0.5 SEC / 1 GAMMA SEN
- 3 FLIGHT ELEVATION 500' MTC (D1094)
- 4 FLIGHT LINES E & W 1/8 MILE APART
- 5 CORRECTED FOR IRRF 1975 UPDATED TO DATE FLOWN
- 6 CONTOUR INTERVAL 10, 50 & 100 GAMMAS
- 7 FLOWN MAY 1979

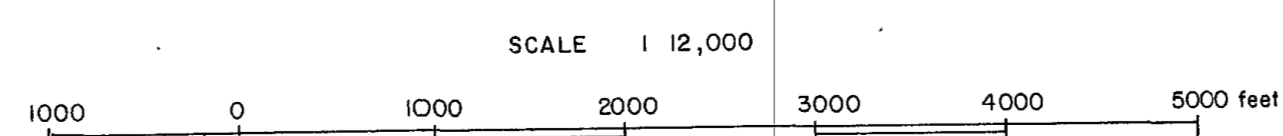

TRUE NORTH
 MAGNETIC NORTH
 ANGLE 10° 35'

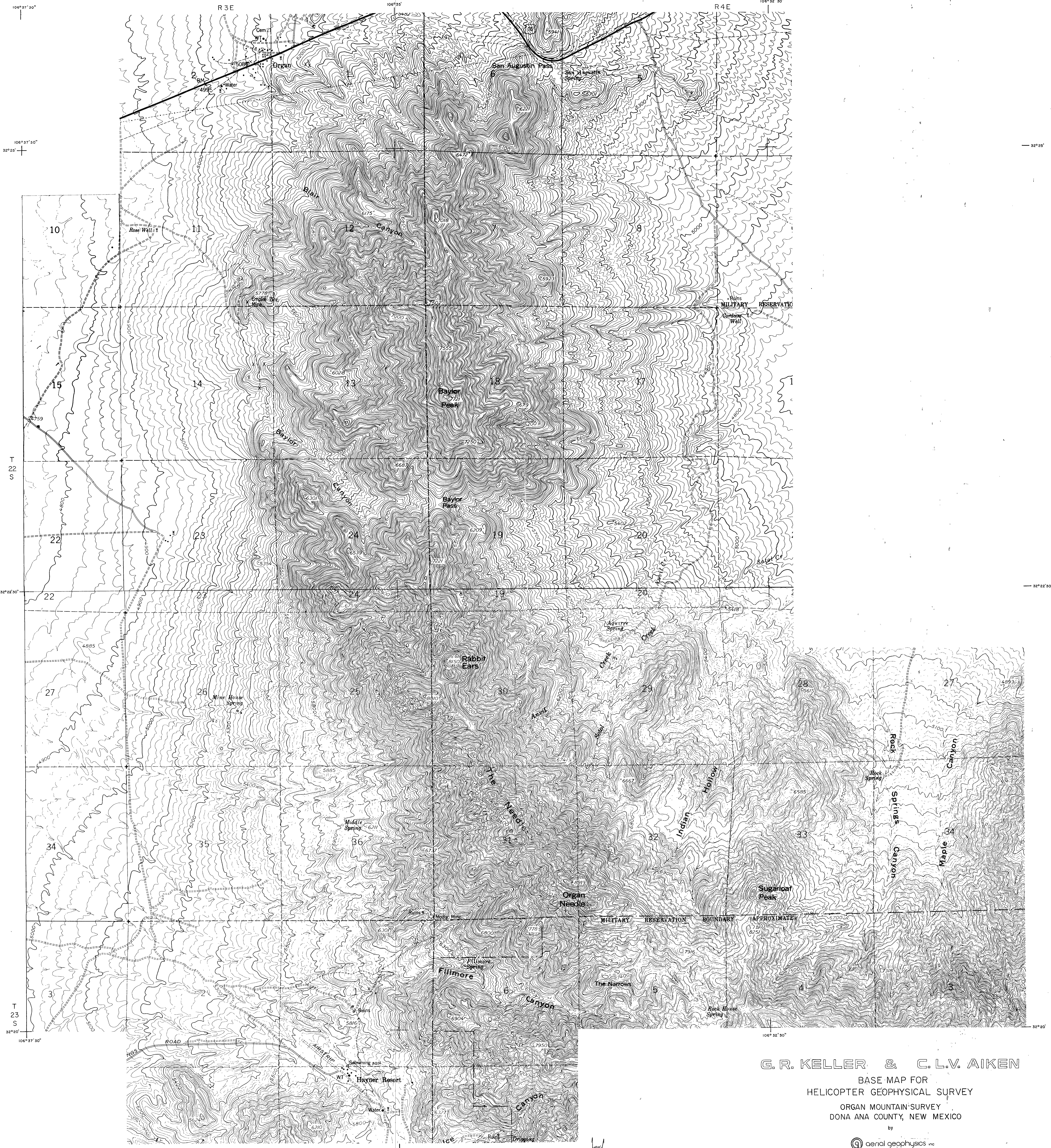

G. R. KELLER & C. L. V. AIKEN
 BASE MAP FOR
 HELICOPTER GEOPHYSICAL SURVEY
 ORGAN MOUNTAIN SURVEY
 DONA ANA COUNTY, NEW MEXICO
 by
 aerial geophysics inc
SALT LAKE CITY, UTAH 84111
 MAY 1979

